



# GIANT 3.0

HEAVY-DUTY MECHANICAL  
ELEVATOR TRAILER SWEEPING MACHINE



MADE IN SWEDEN



# HEAVY-DUTY MECHANICAL ELEVATOR TRAILER SWEEPING MACHINE

Outstanding capacity up to over 1.2 ton per minute

Load coarse waste material quickly and direct from street onto truck



# GIANT 3.0

EASY TO OPERATE  
EASY TO MAINTAIN  
BUILT TO LAST



MADE IN SWEDEN

# GIANT 3.0



HEAVY-DUTY MECHANICAL  
ELEVATOR TRAILER SWEEPING MACHINE



  
NEW COMPACT SWEDISH  
QUALITY DESIGN

**EASY TO OPERATE**  
**EASY TO MAINTAIN**  
**BUILT TO LAST**

Outstanding capacity up to over 1.2 ton per minute  
Load coarse waste material quickly and direct from  
street onto truck

## BENEFITS OF ABL GIANT 3.0

- + Highway transport Speed 80 Km/h
- + Work fast, efficiently between the workplaces
- + Wheel axle with air brake
- + Leaf spring suspension
- + Adjustable sweeping width left/right side brush
- + Outstanding sweeper performance
- + Optimized height/width of conveyor
- + Designed so that systems are accessible and easy to service
- + Low maintenance costs
- + Easy to clean
- + Module design
- + One touch easy control panel in drivers cabin
- + Adjustable water bars
- + Signal horn
- + Conveyor height 3 m

## TECHNICAL SPECIFICATION

<b>Chassis</b>	Built by steel profiles
<b>Weight</b>	ca 3500 service weight total 5070 kg
<b>Sweeping width</b>	2500-3000mm
<b>Hydraulic pump</b>	Gear pump 60 l/min max pressure 150 Bar
<b>Hydraulic motors</b>	Orbit motors
<b>Hydraulic valves</b>	Proportional on/off
<b>Hydraulic filters</b>	High pressure filter
<b>Hydraulic tank</b>	130 liter or specific
<b>Remote box</b>	Can - Bus display
<b>Water tank</b>	2x700 liter or specific
<b>Water pump</b>	2 electric 12v membrane pump
<b>Pressure water</b>	3,5 Bar
<b>Capacity water</b>	32 liter/min
<b>Water spray nozzles</b>	10 units
<b>Rims</b>	17,5"
<b>Tires</b>	215/75 R17.5
<b>Air pressure</b>	675 kpa
<b>Wheel axle</b>	6,5 tons with spring leaf, drum brakes
<b>Parking leg</b>	Hydraulic adjustable in height
<b>Towing bar</b>	Adjustable in height
<b>Towing eyelet</b>	Rockinger 40mm or country specific
<b>Centre brush</b>	Floating automatic suspension

<b>Inner core centre brush</b>	Welded steel
<b>Brush material</b>	Plastic/steel or steel/plastic mixed
<b>Diameter centre brush</b>	750mm
<b>Width centre brush</b>	1016mm
<b>Two side brush</b>	Floating automatic system
<b>Diameter side brush</b>	1300mm
<b>Elevator belts</b>	3
<b>Elevator rakes</b>	20
<b>Elevator safety door</b>	1
<b>Conveyor belt</b>	Width 900mm
<b>Wind cover conveyor</b>	1
<b>Auxiliary engine</b>	CAT, Yanmar 62,5kw
<b>Number of cylinders</b>	4
<b>Power output</b>	62,5 kW 2200-2400 rpm
<b>Automatic engine stop</b>	Low oil pressure overheated engine
<b>Air filter engine</b>	Filter with cyclone precleaner
<b>Cooling system</b>	Combi cooler water/hydraulic oil
<b>Diesel tank</b>	130 liter or specific
<b>Level indicator all tanks</b>	Visual on tank
<b>Sweeping speed</b>	1-20 km/h
<b>Transport speed limit</b>	80 km/h

## MAIN DIMENSION FRONT VIEW

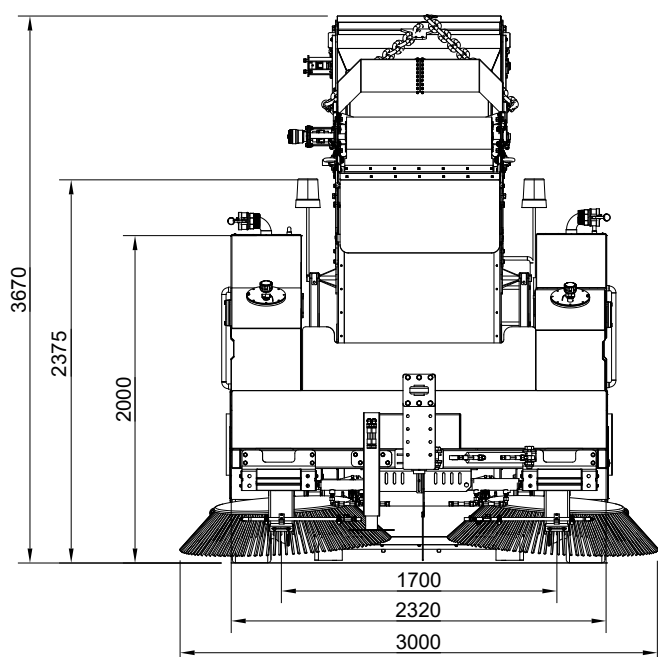

## MAIN DIMENSION REAR VIEW

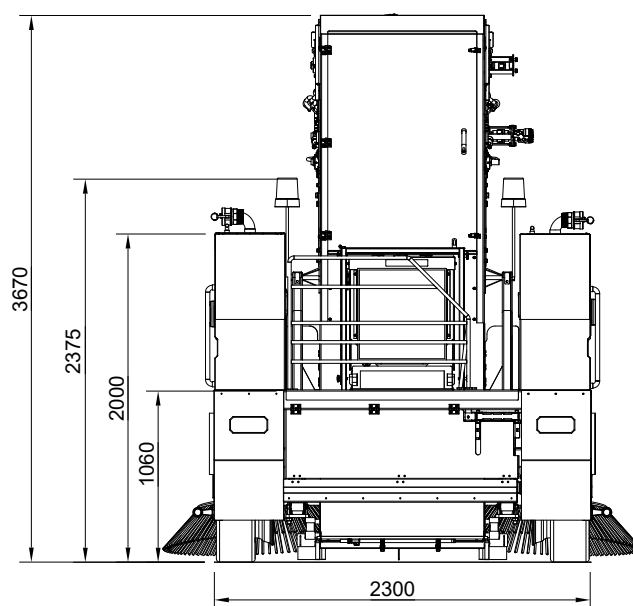



## ABL GIANT 3.0 IS BUILT ON MODULE DESIGN

Water tank, hydraulic tank, diesel tank are separate units

Material and size can be selected according to wishes before production starts

And it is also easy to replace any of these if needed

The ABL GIANT 3.0 module systems make it very easy to service machine as these can be easily removed

### » STANDARD

- » Adjustable speed conveyor
- » Manually parking leg
- » Working lights
- » Electric water pump
- » Automatic brush suspension
- » Wheel axle with spring leaf
- » Remote box Can-bus display
- » Level indicator water/diesel/hydraulic tank
- » Signal horn
- » Toolbox

### + OPTION

- + Rear view camera
- + Hydraulic sweeping width on both side brushes
- + Hydraulic adjustable drawbar
- + Hydraulic water pump
- + Hydraulic parking leg
- + High pressure washer
- + Air brakes
- + Central lubrication
- + Ventilator to reduce the dust
- + Adjustable water bars
- + Wireless remote control
- + Digital level indicator in display  
Water/Diesel/Hydraulic tank

## WITH ABL ES SWEEP CONTROL, SWEEPING BECOMES A PLEASURE

ABL ES Sweep Control, has been developed based on a Clear goal. We want to make it easier for the driver to Work.



### + FOUR STRONG ADVANTAGES OF ABL ES SWEEP CONTROL

- 1 Simplicity**  
Functions are controlled with joystick and a display, this make handling easy. The driver receives continuous feedback from machine during his work session.
- 2 Flexibility**  
System handles all sweeper functions and applications.
- 3 Modern interface**  
Stylish and logically constructed control panel shows simple function and selected setting values.
- 4 Reliable**  
The system is robust and tested to manage tough working environments, and tough climates

### » MAIN DIMENSION SIDE VIEW

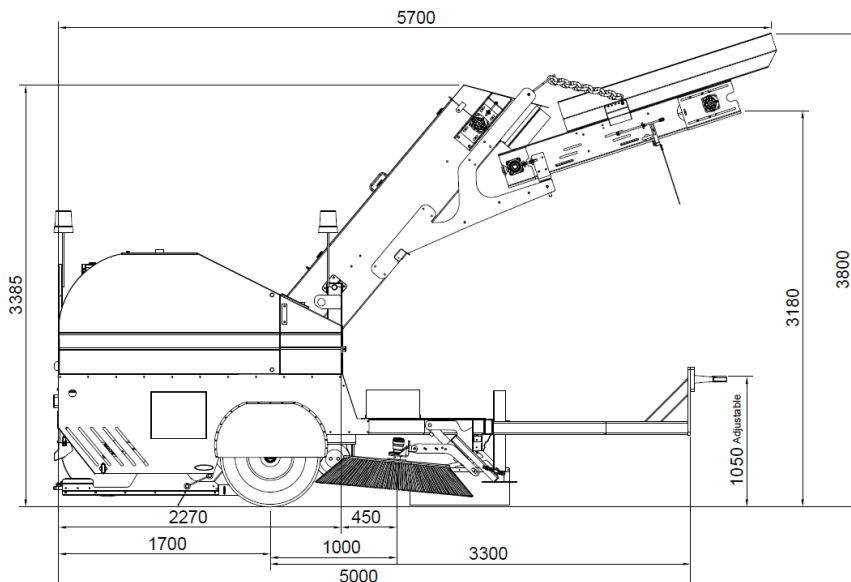

### » MAIN DIMENSION COMPONENTS

1. Watertank
2. Hydraulic tank
3. Diesel tank
4. Diesel engine
5. Elevator
6. Conveyour
7. Hydraulic valves
8. Side brush
9. Centre brush
10. Wheel axle
11. Motor hood
12. Support leg
13. Collector shoe
14. Towing bar
15. Side cover

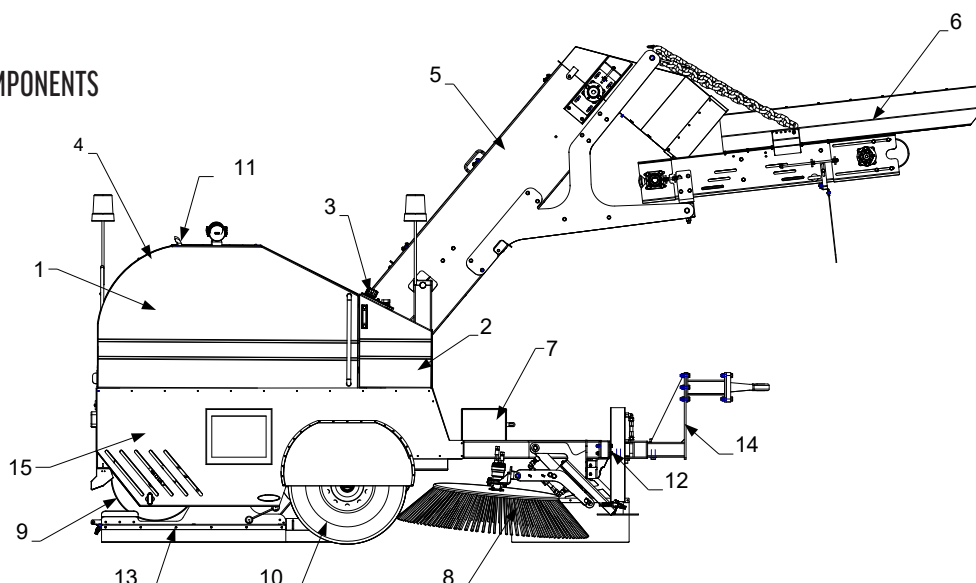



**FEEL FREE TO CONTACT US**

ABL CONSTRUCTION EQUIPMENT AB  
SVETSAREGATAN 1  
SE-576 33 SÄVSJÖ SWEDEN

**MOBILE** +46(0)38 267 600

**EMAIL** [info@abl.se](mailto:info@abl.se)

**WEB** [www.abl.se](http://www.abl.se)

ABL CE has a long experience in production of tools and equipment for construction machinery. ABL CE was established 1960 and has since then been a leader of equipment to wheel loaders, excavators, telescopic loaders, timber and forest industry. All design and manufacturing is produced in our factory in Sweden which enables us to develop truly unique and custom made products for your specific needs.

