

MBX

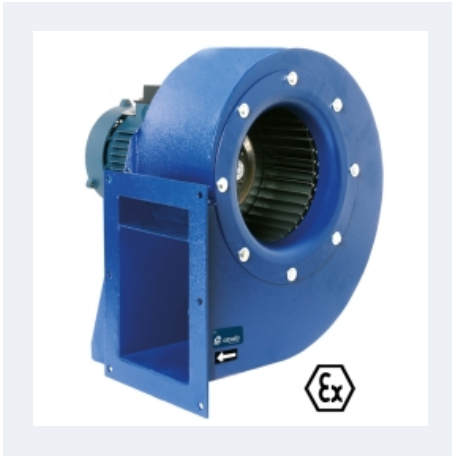

CENTRIFUGAL MEDIUM PRESSURE ATEX FAN

MANUFACTURING FEATURES

- Rolling steel sheet housing.
- Completely joined or welded housing.
- Simple inlet forward curved impeller made of aluminium sheet.
- Polyester powder finishing coat.
- Inlet sparkproof ring made of copper or aluminium.
- ATEX standard asynchronous motor. ATEX certified according to the zone. IP55 protection, and class F insulation. Manufactured with standard voltages: 230V 50Hz for single phase motors, 230/400V 50Hz in three phase motors up to 4kW and 400/690V 50Hz for higher powers.
- Standard orientation: LG270.

APPLICATIONS

Designed for inline installation, they are suitable for:

- Ventilation in indoor environments classified as ATEX
- Working temperature: ambient from -20°C to 40°C, transported air according to the ATEX classification.
- Suitable for transporting totally clean air without dust.

UNDER REQUEST

- 60Hz fans and special voltages.
- Orientation: RD0, RD45, RD90, RD135, RD180, RD225, RD270, RD315, LG0, LG45, LG90, LG135, LG180. LG225, LG315.

ORGANISM: L.O.M.

CERTIFICAT N°: LOM 17.407N-C

In compliance with the Directive 2014/34/UE

Accessories



AB



AC



AVR



AVS



BA-400



EI



FS



INT



**INT
ATEX**



JE 45



RA



RBS



SFC

Technical data

Single-phase motor / 2 poles

| Code | Model | R.P.M. | Rated I. A 230V | Rated power kW | Max. Airflow m ³ /h | Sound db (A)** | Weight kg | Connect. diagram |
|-------------|--------------------|--------|--------------------|-------------------|--------------------------------------|-------------------|--------------|---------------------|
| 253100103XD | MBX 14/5 M2 0,25kW | 2800 | 1,87 | 0,25 | 840 | 58 | 7 | 1 |
| 253110103XD | MBX 16/6 M2 0,37kW | 2800 | 2,61 | 0,37 | 1.080 | 60 | 9,50 | 1 |
| 253170103XD | MBX 18/7 M2 0,75kW | 2800 | 4,93 | 0,75 | 1.470 | 63 | 15 | 1 |
| 253240103XD | MBX 20/6 M2 0,37kW | 2800 | 2,61 | 0,37 | 785 | 61 | 14 | 1 |
| 253190103XD | MBX 20/8 M2 1,1kW | 2800 | 6,71 | 1,10 | 1.960 | 65 | 19 | 1 |

Single-phase motor / 4 poles

| Code | Model | R.P.M. | Rated I. A 230V | Rated power kW | Max. Airflow m ³ /h | Sound db (A)** | Weight kg | Connect. diagram |
|-------------|--------------------|--------|--------------------|-------------------|--------------------------------------|-------------------|--------------|---------------------|
| 253080103XD | MBX 12/5 M4 0,08kW | 1370 | 0,9 | 0,08 | 250 | 46 | 5 | 1 |
| 253090103XD | MBX 14/5 M4 0,08kW | 1370 | 0,9 | 0,08 | 414 | 46 | 6 | 1 |
| 253150103XD | MBX 16/6 M4 0,08kW | 1370 | 0,9 | 0,08 | 600 | 53 | 7,50 | 1 |

Three-phase motor / 2 poles

| Code | Model | R.P.M. | Rated I. A 400V | Rated power kW | Max. Airflow m ³ /h | Sound db (A)** | Weight kg | Connect. diagram |
|-------------|--------------------|--------|--------------------|-------------------|--------------------------------------|-------------------|--------------|---------------------|
| 253100106XN | MBX 14/5 T2 0,25kW | 2750 | 0,74 | 0,25 | 840 | 58 | 7 | 2 |
| 253110106XN | MBX 16/6 T2 0,37kW | 2850 | 1,00 | 0,37 | 1.080 | 60 | 9,50 | 2 |
| 253170106XN | MBX 18/7 T2 0,75kW | 2870 | 2,00 | 0,75 | 1.470 | 63 | 15 | 2 |
| 253240106XN | MBX 20/6 T2 0,37kW | 2850 | 1,00 | 0,37 | 785 | 61 | 14 | 2 |
| 253190106XN | MBX 20/8 T2 1,1kW | 2830 | 2,6 | 1,10 | 1.960 | 65 | 19 | 2 |
| 253210120XN | MBX 22/9 T2 1,1kW | 2830 | 2,6 | 1,10 | 1.480 | 55 | 24 | 2 |
| 253200106XN | MBX 22/9 T2 2,2kW | 2840 | 5,4 | 2,20 | 2.890 | 65 | 30 | 2 |
| 253280106XN | MBX 25/10 T2 2,2kW | 2840 | 5,4 | 2,20 | 2.540 | 62 | 32 | 2 |
| 253290106XN | MBX 25/10 T2 3kW | 2900 | 7,3 | 3,00 | 3.360 | 66 | 38 | 2 |
| 253360106XN | MBX 28/11 T2 4kW | 2910 | 9,2 | 4,00 | 3.800 | 70 | 46 | 2 |

Three-phase motor / 4 poles

| Code | Model | R.P.M. | Rated I. A 400V | Rated power kW | Max. Airflow m ³ /h | Sound db (A)** | Weight kg | Connect. diagram |
|-------------|--------------------|--------|--------------------|-------------------|--------------------------------------|-------------------|--------------|---------------------|
| 253080106XN | MBX 12/5 T4 0,08kW | 1450 | 0,46 | 0,09 | 250 | 46 | 5 | 2 |

| Code | Model | R.P.M. | Rated I. A 400V | Rated power kW | Max. Airflow m ³ /h | Sound db (A)** | Weight kg | Connect. diagram |
|-------------|---------------------|--------|--------------------|-------------------|--------------------------------------|----------------------|--------------|---------------------|
| 253090106XN | MBX 14/5 T4 0,08kW | 1450 | 0,46 | 0,09 | 414 | 46 | 6 | 2 |
| 253150106XN | MBX 16/6 T4 0,08kW | 1450 | 0,46 | 0,09 | 600 | 53 | 7,50 | 2 |
| 253260106XN | MBX 22/9 T4 0,37kW | 1410 | 1,2 | 0,37 | 1.830 | 59 | 21 | 2 |
| 253320106XN | MBX 25/10 T4 0,75kW | 1410 | 2,1 | 0,75 | 2.830 | 59 | 26 | 2 |
| 253410106XN | MBX 28/11 T4 1,1kW | 1420 | 3,3 | 1,10 | 3.580 | 65 | 32 | 2 |
| 253420106XN | MBX 31/12 T4 2,2kW | 1440 | 5,8 | 2,20 | 5.400 | 63 | 54 | 2 |
| 253480106XN | MBX 35/14 T4 3kW | 1420 | 6,8 | 3,00 | 5.870 | 65 | 63 | 2 |
| 253490106XN | MBX 35/14 T4 4kW | 1450 | 9,1 | 4,00 | 8.020 | 64 | 69 | 2 |
| 253510121XN | MBX 40/16 T4 5,5kW | 1455 | 11,5 | 5,50 | 8.340 | 68 | 101 | 2 |
| 253510106XN | MBX 40/16 T4 7,5kW | 1448 | 15,6 | 7,50 | 10.570 | 72 | 110 | 2 |
| 253530120XN | MBX 45/18 T4 7,5kW | 1448 | 15,6 | 7,50 | 9.160 | 75 | 119 | 2 |
| 253530121XN | MBX 45/18 T4 11kW | 1460 | 20,9 | 11,00 | 12.500 | 76 | 190 | 2 |

Three-phase motor / 6 poles

| Code | Model | R.P.M. | Rated I. A 400V | Rated power kW | Max. Airflow m ³ /h | Sound db (A)** | Weight kg | Connect. diagram |
|-------------|--------------------|--------|--------------------|-------------------|--------------------------------------|----------------------|--------------|---------------------|
| 253500106XN | MBX 35/14 T6 1,1kW | 940 | 4,00 | 1,50 | 5.200 | 58 | 53 | 2 |
| 253520106XN | MBX 40/16 T6 1,5kW | 940 | 4,00 | 1,50 | 5.650 | 59 | 94 | 2 |
| 253540106XN | MBX 40/16 T6 2,2kW | 930 | 5,2 | 2,20 | 7.530 | 59 | 94 | 2 |
| 253560106XN | MBX 45/18 T6 2,2kW | 930 | 5,2 | 2,20 | 6.060 | 64 | 112 | 2 |

Notes:

** Total sound pressure level at the point of maximum flow measured in dB(A) in the suction measured in free field at a distance of 6m from the source

Dimensions

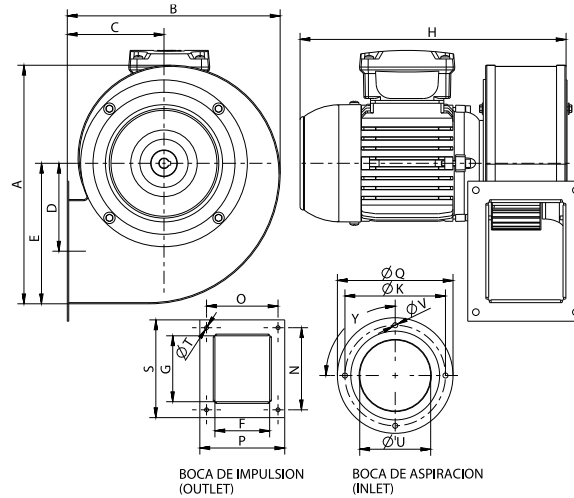

| Model | A | B | C | D | E | F | G | H | K |
|--------------------|-------|-----|-----|-------|-------|-----|-------|-----|-----|
| MBX 12/5 M4 0,08kW | 205,5 | 187 | 87 | 71,5 | 117 | 72 | 81,7 | 251 | 135 |
| MBX 12/5 T4 0,08kW | 205,5 | 187 | 87 | 71,5 | 117 | 72 | 81,7 | 251 | 135 |
| MBX 14/5 M2 0,25kW | 250,5 | 223 | 102 | 93 | 147,5 | 78 | 102 | 278 | 162 |
| MBX 14/5 M4 0,08kW | 250,5 | 223 | 102 | 93 | 147,5 | 78 | 102 | 278 | 162 |
| MBX 14/5 T2 0,25kW | 250,5 | 223 | 102 | 93 | 147,5 | 78 | 102 | 278 | 162 |
| MBX 14/5 T4 0,08kW | 250,5 | 223 | 102 | 93 | 147,5 | 78 | 102 | 278 | 162 |
| MBX 16/6 M2 0,37kW | 295 | 266 | 119 | 108,5 | 171,5 | 98 | 118 | 325 | 180 |
| MBX 16/6 M4 0,08kW | 295 | 266 | 119 | 108,5 | 171,5 | 98 | 118 | 298 | 180 |
| MBX 16/6 T2 0,37kW | 295 | 266 | 119 | 108,5 | 171,5 | 98 | 118 | 325 | 180 |
| MBX 16/6 T4 0,08kW | 295 | 266 | 119 | 108,5 | 171,5 | 98 | 118 | 298 | 180 |
| MBX 18/7 M2 0,75kW | 365 | 321 | 139 | 141,5 | 213 | 115 | 141,5 | 360 | 214 |
| MBX 18/7 T2 0,75kW | 365 | 321 | 139 | 141,5 | 213 | 115 | 141,5 | 360 | 214 |
| MBX 20/6 M2 0,37kW | 364 | 321 | 141 | 142 | 210 | 105 | 101,5 | 333 | 230 |
| MBX 20/6 T2 0,37kW | 364 | 321 | 141 | 142 | 210 | 105 | 101,5 | 333 | 230 |
| MBX 20/8 M2 1,1kW | 392 | 331 | 140 | 142 | 230 | 130 | 161,5 | 374 | 230 |
| MBX 20/8 T2 1,1kW | 392 | 331 | 140 | 142 | 230 | 130 | 161,5 | 374 | 230 |

| Model | N | O | P | Q | S | TØ | UØ | VØ | Y |
|--------------------|-----|-----|-----|-----|-----|----|------|----|-------|
| MBX 12/5 M4 0,08kW | 105 | 93 | 106 | 150 | 118 | 7 | 92,5 | 7 | 4x90º |
| MBX 12/5 T4 0,08kW | 105 | 93 | 106 | 150 | 118 | 7 | 92,5 | 7 | 4x90º |
| MBX 14/5 M2 0,25kW | 128 | 105 | 122 | 175 | 147 | 7 | 115 | 7 | 4x90º |
| MBX 14/5 M4 0,08kW | 128 | 105 | 122 | 175 | 147 | 7 | 115 | 7 | 4x90º |
| MBX 14/5 T2 0,25kW | 128 | 105 | 122 | 175 | 147 | 7 | 115 | 7 | 4x90º |
| MBX 14/5 T4 0,08kW | 128 | 105 | 122 | 175 | 147 | 7 | 115 | 7 | 4x90º |
| MBX 16/6 M2 0,37kW | 147 | 128 | 152 | 207 | 175 | 7 | 127 | 9 | 4x90º |

| Model | N | O | P | Q | S | TØ | UØ | VØ | Y |
|--------------------|-----|-----|-----|-----|-----|----|-----|----|-------|
| MBX 16/6 M4 0,08kW | 147 | 128 | 152 | 207 | 175 | 7 | 127 | 9 | 4x90° |
| MBX 16/6 T2 0,37kW | 147 | 128 | 152 | 207 | 175 | 7 | 127 | 9 | 4x90° |
| MBX 16/6 T4 0,08kW | 147 | 128 | 152 | 207 | 175 | 7 | 127 | 9 | 4x90° |
| MBX 18/7 M2 0,75kW | 169 | 146 | 169 | 237 | 192 | 9 | 143 | 9 | 4x90° |
| MBX 18/7 T2 0,75kW | 169 | 146 | 169 | 237 | 192 | 9 | 143 | 9 | 4x90° |
| MBX 20/6 M2 0,37kW | 128 | 134 | 159 | 255 | 153 | 9 | 161 | 9 | 8x45° |
| MBX 20/6 T2 0,37kW | 128 | 134 | 159 | 255 | 153 | 9 | 161 | 9 | 8x45° |
| MBX 20/8 M2 1,1kW | 189 | 160 | 184 | 255 | 213 | 9 | 161 | 9 | 8x45° |
| MBX 20/8 T2 1,1kW | 189 | 160 | 184 | 255 | 213 | 9 | 161 | 9 | 8x45° |

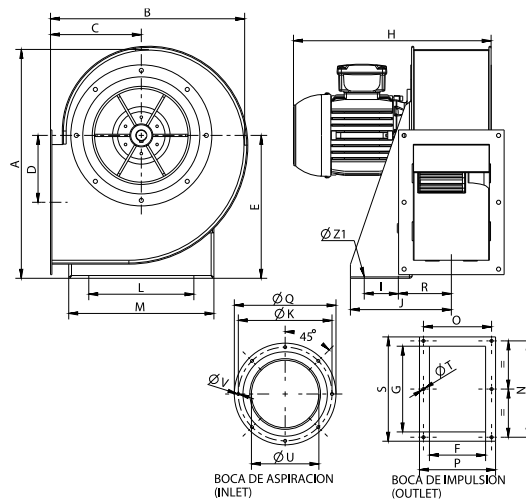

| Model | A | B | C | D | E | F | G | H | I |
|---------------------|-------|-------|-----|-------|-----|-----|-----|-------|----|
| MBX 22/9 T2 1,1kW | 455 | 393,5 | 184 | 140 | 280 | 140 | 216 | 385,5 | 50 |
| MBX 22/9 T2 2,2kW | 455 | 393,5 | 184 | 140 | 280 | 140 | 216 | 429 | 50 |
| MBX 22/9 T4 0,37kW | 455 | 393,5 | 184 | 140 | 280 | 140 | 216 | 369,5 | 50 |
| MBX 25/10 T2 2,2kW | 502,5 | 429 | 197 | 150,5 | 310 | 165 | 254 | 463 | 74 |
| MBX 25/10 T2 3kW | 502,5 | 429 | 197 | 150,5 | 310 | 165 | 254 | 498 | 74 |
| MBX 25/10 T4 0,75kW | 502,5 | 429 | 197 | 150,5 | 310 | 165 | 254 | 427 | 74 |
| MBX 28/11 T2 4kW | 555 | 475 | 216 | 160 | 340 | 176 | 300 | 529,5 | 95 |
| MBX 28/11 T4 1,1kW | 555 | 475 | 216 | 160 | 340 | 176 | 300 | 453,5 | 95 |

| Model | J | K | L | M | N | O | P | Q | R |
|--------------------|-------|-----|-----|-----|-----|-----|-----|-----|-------|
| MBX 22/9 T2 1,1kW | 182,5 | 256 | 220 | 290 | 256 | 180 | 204 | 280 | 102 |
| MBX 22/9 T2 2,2kW | 182,5 | 256 | 220 | 290 | 256 | 180 | 204 | 280 | 102 |
| MBX 22/9 T4 0,37kW | 182,5 | 256 | 220 | 290 | 256 | 180 | 204 | 280 | 102 |
| MBX 25/10 T2 2,2kW | 219 | 282 | 228 | 315 | 290 | 205 | 229 | 306 | 114,5 |
| MBX 25/10 T2 3kW | 219 | 282 | 228 | 315 | 290 | 205 | 229 | 306 | 114,5 |

| Model | J | K | L | M | N | O | P | Q | R |
|---------------------|-------|-----|-----|-----|-----|-----|-----|-----|-------|
| MBX 25/10 T4 0,75kW | 219 | 282 | 228 | 315 | 290 | 205 | 229 | 306 | 114,5 |
| MBX 28/11 T2 4kW | 234.5 | 320 | 245 | 350 | 340 | 220 | 244 | 348 | 110 |
| MBX 28/11 T4 1,1kW | 234.5 | 320 | 245 | 350 | 340 | 220 | 244 | 348 | 110 |

| Model | S | TØ | UØ | VØ | Z1Ø |
|---------------------|-----|----|-----|----|-----|
| MBX 22/9 T2 1,1kW | 282 | 9 | 180 | 9 | 11 |
| MBX 22/9 T2 2,2kW | 282 | 9 | 180 | 9 | 11 |
| MBX 22/9 T4 0,37kW | 282 | 9 | 180 | 9 | 11 |
| MBX 25/10 T2 2,2kW | 314 | 9 | 203 | 9 | 11 |
| MBX 25/10 T2 3kW | 314 | 9 | 203 | 9 | 11 |
| MBX 25/10 T4 0,75kW | 314 | 9 | 203 | 9 | 11 |
| MBX 28/11 T2 4kW | 364 | 11 | 228 | 9 | 11 |
| MBX 28/11 T4 1,1kW | 364 | 11 | 228 | 9 | 11 |

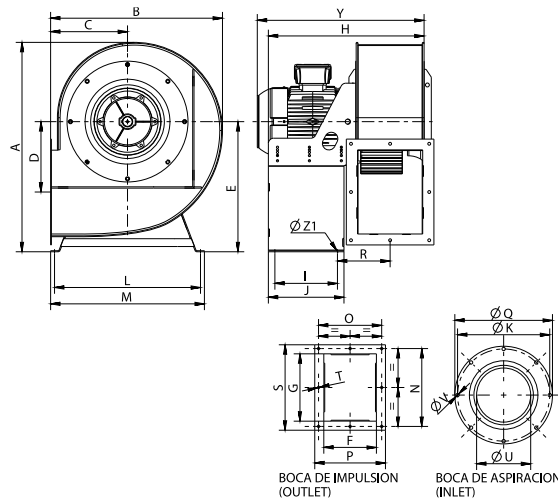

| Model | A | B | C | D | E | F | G | H | I |
|--------------------|-----|-----|-----|-------|-----|-----|-----|-----|-----|
| MBX 31/12 T4 2,2kW | 646 | 537 | 249 | 186 | 406 | 198 | 319 | 538 | 240 |
| MBX 35/14 T4 3kW | 722 | 593 | 270 | 249,5 | 451 | 224 | 280 | 564 | 240 |
| MBX 35/14 T4 4kW | 722 | 593 | 270 | 249,5 | 451 | 224 | 280 | 564 | 240 |
| MBX 35/14 T6 1,1kW | 722 | 593 | 270 | 249,5 | 451 | 224 | 280 | 564 | 240 |

| Model | J | K | L | M | N | O | P | Q | R |
|--------------------|-----|-------|-----|-----|-----|-----|-----|-----|-----|
| MBX 31/12 T4 2,2kW | 290 | 354,5 | 457 | 482 | 360 | 240 | 274 | 382 | 171 |
| MBX 35/14 T4 3kW | 290 | 394,5 | 449 | 474 | 318 | 266 | 300 | 422 | 184 |
| MBX 35/14 T4 4kW | 290 | 394,5 | 449 | 474 | 318 | 266 | 300 | 422 | 184 |
| MBX 35/14 T6 1,1kW | 290 | 394,5 | 449 | 474 | 318 | 266 | 300 | 422 | 184 |

| Model | S | TØ | UØ | VØ | Y | Z1 |
|--------------------|-----|----|-----|----|--------|----|
| MBX 31/12 T4 2,2kW | 395 | 11 | 257 | 11 | 539,5 | 13 |
| MBX 35/14 T4 3kW | 356 | 11 | 289 | 11 | 565,75 | 13 |
| MBX 35/14 T4 4kW | 356 | 11 | 289 | 11 | 600 | 13 |
| MBX 35/14 T6 1,1kW | 356 | 11 | 289 | 11 | 540 | 13 |

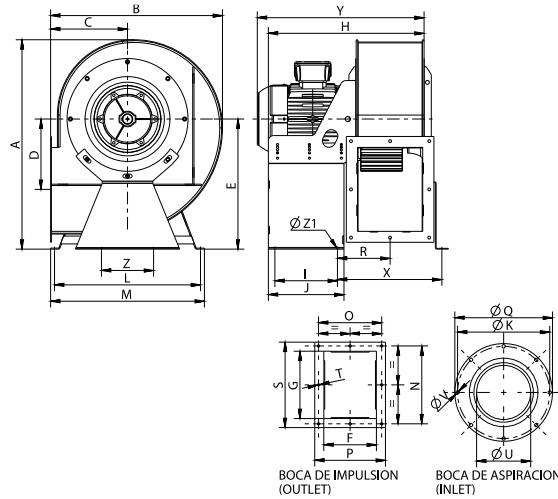

| Model | A | B | C | D | E | F | G | H | I |
|--------------------|-----|-----|-----|-------|-----|-----|-----|-----|-----|
| MBX 40/16 T4 5,5kW | 802 | 658 | 295 | 279 | 499 | 250 | 320 | 595 | 240 |
| MBX 40/16 T4 7,5kW | 802 | 658 | 295 | 279 | 499 | 250 | 320 | 595 | 240 |
| MBX 40/16 T6 1,5kW | 802 | 658 | 295 | 279 | 499 | 250 | 320 | 595 | 240 |
| MBX 40/16 T6 2,2kW | 802 | 658 | 295 | 279 | 499 | 250 | 320 | 595 | 240 |
| MBX 45/18 T4 7,5kW | 891 | 737 | 329 | 314,5 | 553 | 280 | 360 | 791 | 250 |
| MBX 45/18 T4 11kW | 891 | 737 | 329 | 314,5 | 553 | 280 | 360 | 791 | 400 |
| MBX 45/18 T6 2,2kW | 891 | 737 | 329 | 314,5 | 553 | 280 | 360 | 791 | 250 |

| Model | J | K | L | M | N | O | P | Q | R |
|--------------------|-----|-----|-----|-----|-----|-----|-----|-----|-----|
| MBX 40/16 T4 5,5kW | 290 | 438 | 560 | 590 | 370 | 300 | 336 | 464 | 202 |
| MBX 40/16 T4 7,5kW | 290 | 438 | 560 | 590 | 370 | 300 | 336 | 464 | 202 |
| MBX 40/16 T6 1,5kW | 290 | 438 | 560 | 590 | 370 | 300 | 336 | 464 | 202 |
| MBX 40/16 T6 2,2kW | 290 | 438 | 560 | 590 | 370 | 300 | 336 | 464 | 202 |
| MBX 45/18 T4 7,5kW | 300 | 485 | 602 | 632 | 404 | 328 | 356 | 515 | 207 |
| MBX 45/18 T4 11kW | 450 | 485 | 602 | 632 | 404 | 328 | 356 | 515 | 207 |
| MBX 45/18 T6 2,2kW | 300 | 485 | 602 | 632 | 404 | 328 | 356 | 515 | 207 |

| Model | S | TØ | UØ | VØ | X | Y | Z | Z1 |
|--------------------|-----|----|-----|----|-----|--------|-----|----|
| MBX 40/16 T4 5,5kW | 406 | 11 | 325 | 11 | 400 | 667,75 | 200 | 13 |
| MBX 40/16 T4 7,5kW | 406 | 11 | 325 | 11 | 400 | 707,75 | 200 | 13 |

| Model | S | TØ | UØ | VØ | X | Y | Z | Z1 |
|--------------------|-----|----|-----|----|-----|--------|-----|----|
| MBX 40/16 T6 1,5kW | 406 | 11 | 325 | 11 | 400 | 612,75 | 200 | 13 |
| MBX 40/16 T6 2,2kW | 406 | 11 | 325 | 11 | 400 | 612,75 | 200 | 13 |
| MBX 45/18 T4 7,5kW | 436 | 11 | 365 | 11 | 415 | 726,75 | 200 | 13 |
| MBX 45/18 T4 11kW | 436 | 11 | 365 | 11 | 430 | 802,75 | 200 | 13 |
| MBX 45/18 T6 2,2kW | 436 | 11 | 365 | 11 | 415 | 631,75 | 200 | 13 |

Wiring diagram

Wiring diagram N° 1

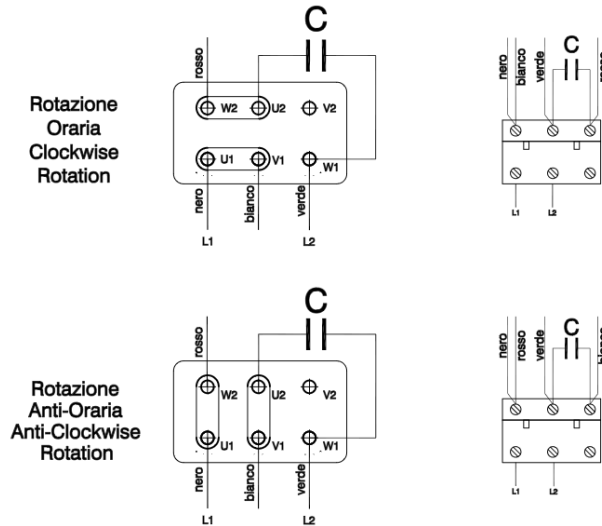

Wiring diagram N° 2

230/400V

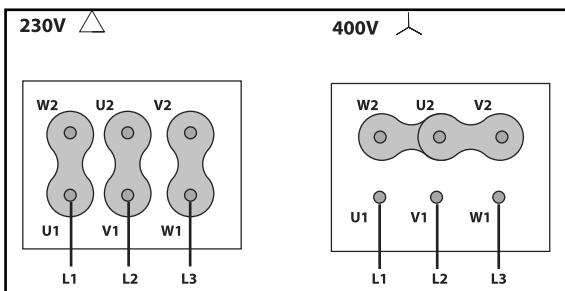

400/690V

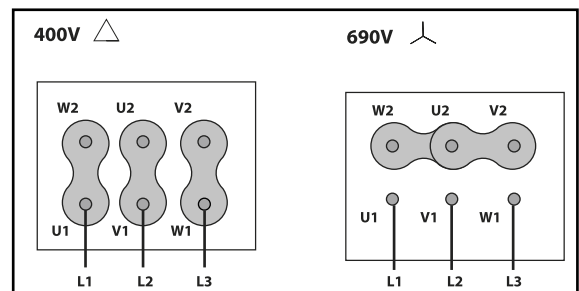

CHARACTERISTIC CURVE

- | | | | | | | | |
|---|--------------------|---|--------------------|---|--------------------|---|--------------------|
| 1 | MBX 14/5 M2 0,25kW | 2 | MBX 16/6 M2 0,37kW | 3 | MBX 18/7 M2 0,75kW | 4 | MBX 20/6 M2 0,37kW |
| 5 | MBX 20/8 M2 1,1kW | | | | | | |

AIR FLOW - PRESSURE

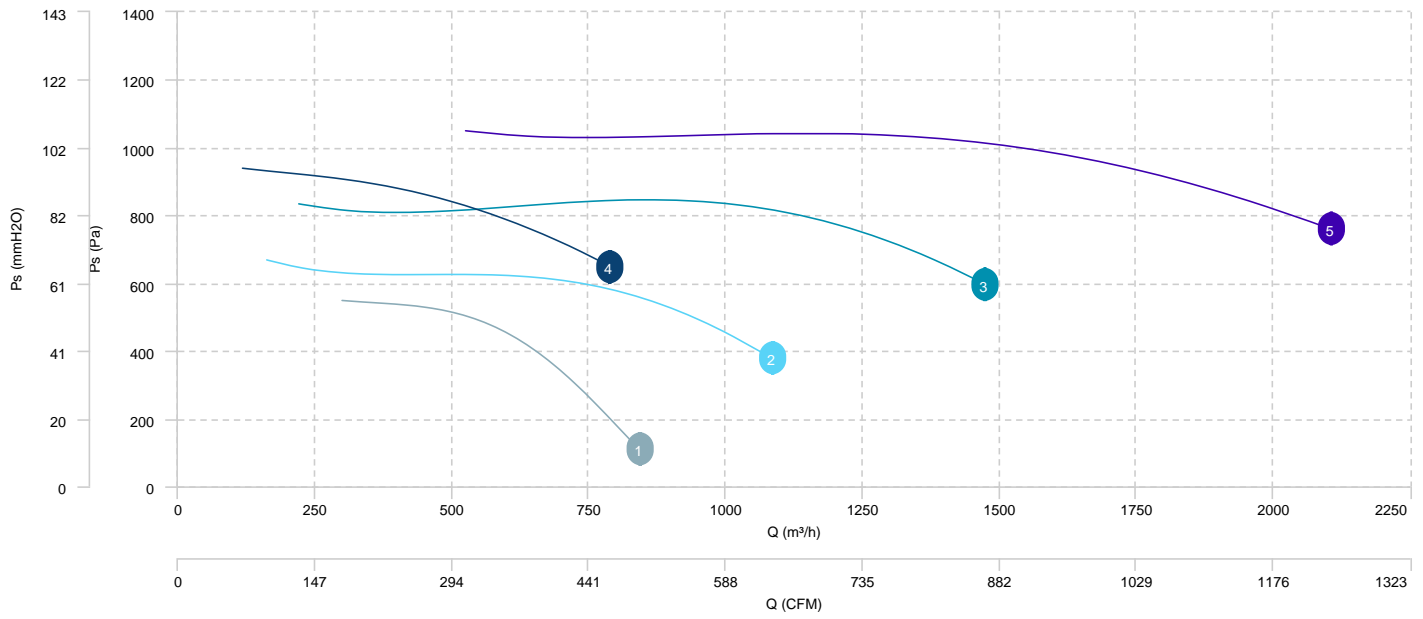

1 MBX 12/5 M4 0,08kW

2 MBX 14/5 M4 0,08kW

3 MBX 16/6 M4 0,08kW

AIR FLOW - PRESSURE

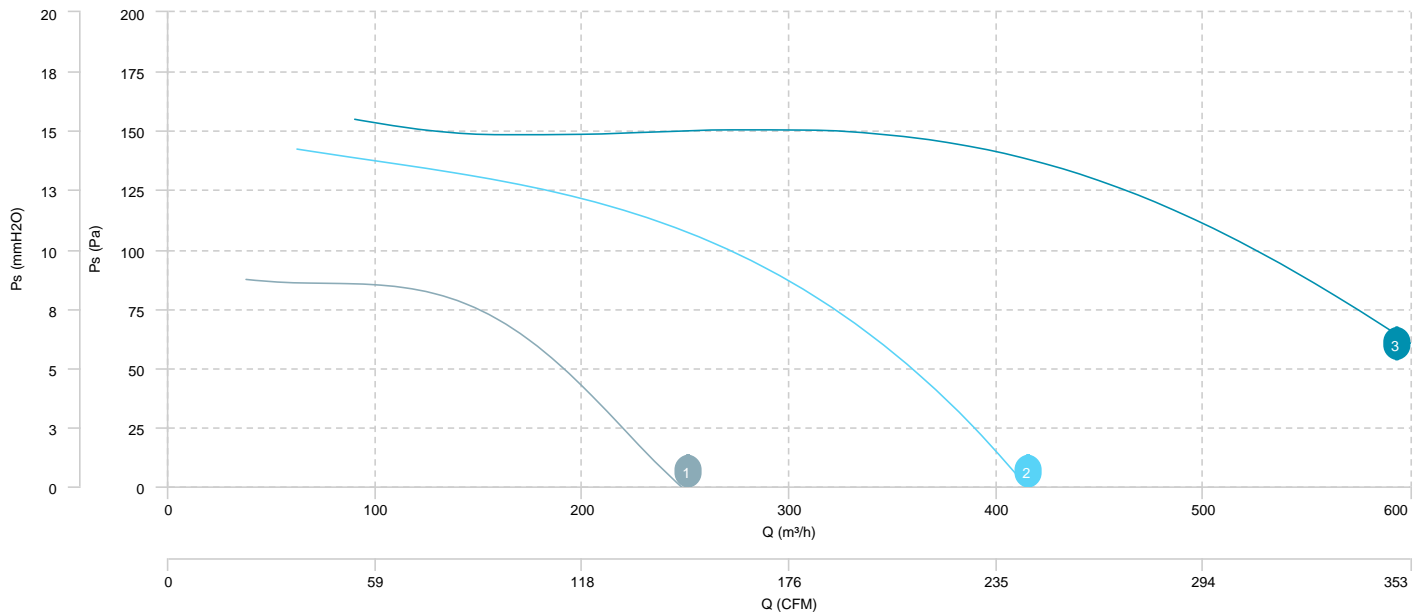

| | | | | | | | |
|---|--------------------|----|--------------------|---|--------------------|---|--------------------|
| 1 | MBX 14/5 T2 0,25kW | 2 | MBX 16/6 T2 0,37kW | 3 | MBX 18/7 T2 0,75kW | 4 | MBX 20/6 T2 0,37kW |
| 5 | MBX 20/8 T2 1,1kW | 6 | MBX 22/9 T2 1,1kW | 7 | MBX 22/9 T2 2,2kW | 8 | MBX 25/10 T2 2,2kW |
| 9 | MBX 25/10 T2 3kW | 10 | MBX 28/11 T2 4kW | | | | |

AIR FLOW - PRESSURE

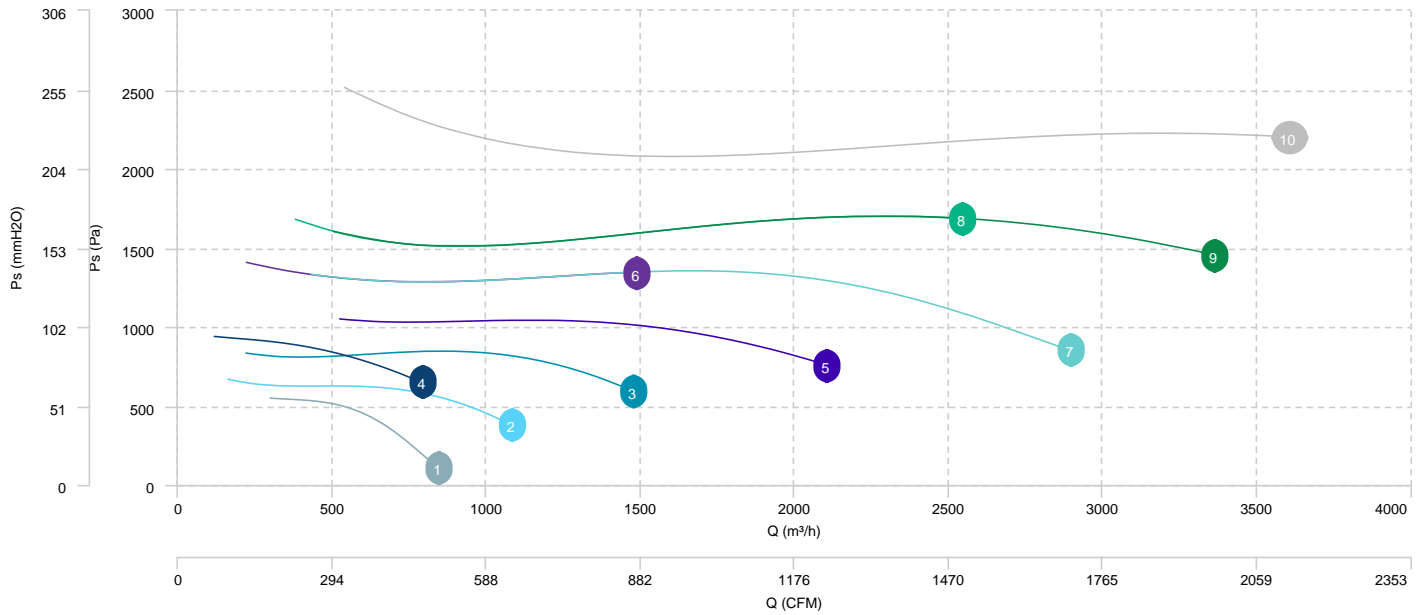

| | | | | | | | |
|---|---------------------|---|--------------------|---|--------------------|---|--------------------|
| 1 | MBX 12/5 T4 0,08kW | 2 | MBX 14/5 T4 0,08kW | 3 | MBX 16/6 T4 0,08kW | 4 | MBX 22/9 T4 0,37kW |
| 5 | MBX 25/10 T4 0,75kW | 6 | MBX 28/11 T4 1,1kW | 7 | MBX 31/12 T4 2,2kW | | |

AIR FLOW - PRESSURE

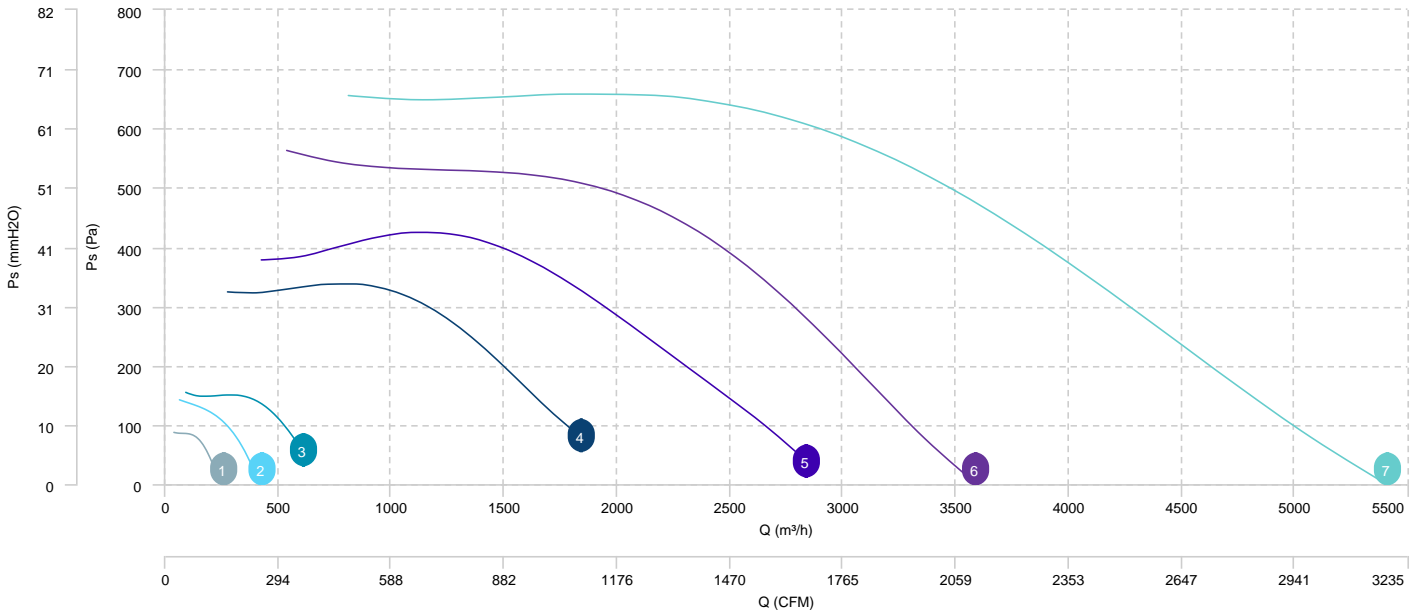

| | | | | | | | |
|---|--------------------|---|-------------------|---|--------------------|---|--------------------|
| 1 | MBX 35/14 T4 3kW | 2 | MBX 35/14 T4 4kW | 3 | MBX 40/16 T4 5,5kW | 4 | MBX 40/16 T4 7,5kW |
| 5 | MBX 45/18 T4 7,5kW | 6 | MBX 45/18 T4 11kW | | | | |

AIR FLOW - PRESSURE

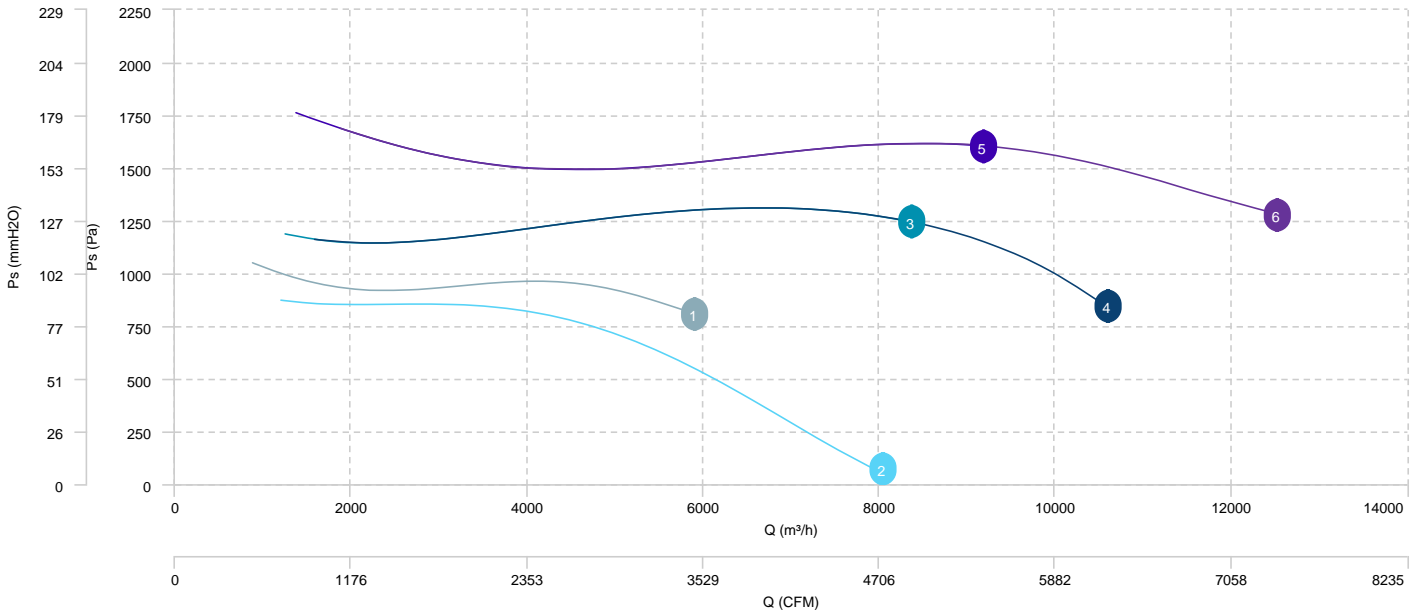

1 MBX 35/14 T6 1,1kW

2 MBX 40/16 T6 1,5kW

3 MBX 40/16 T6 2,2kW

4 MBX 45/18 T6 2,2kW

AIR FLOW - PRESSURE

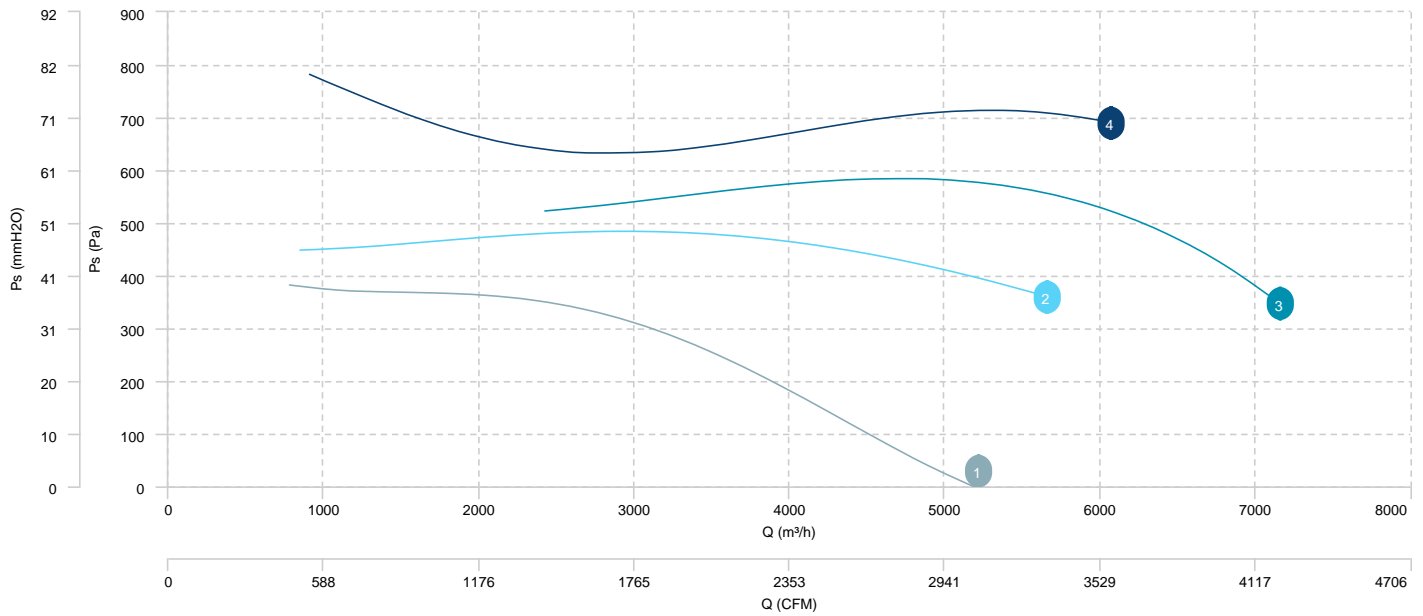

Sound data

Sound / 2 poles

| Sound power Lw dB (A) | | | | | | | | | | |
|-----------------------|-------|-------|--------|--------|--------|---------|---------|---------|---------|-------|
| Model | | 63 Hz | 125 Hz | 250 Hz | 500 Hz | 1000 Hz | 2000 Hz | 4000 Hz | 8000 Hz | Total |
| MBX 14/5 M2 0,25kW | Inlet | 49 | 60 | 71 | 74 | 76 | 80 | 76 | 74 | 84 |
| MBX 14/5 T2 0,25kW | Inlet | 49 | 60 | 71 | 74 | 76 | 80 | 76 | 74 | 84 |
| MBX 16/6 M2 0,37kW | Inlet | 51 | 63 | 74 | 77 | 79 | 83 | 78 | 76 | 86 |
| MBX 16/6 T2 0,37kW | Inlet | 51 | 63 | 74 | 77 | 79 | 83 | 78 | 76 | 86 |
| MBX 18/7 M2 0,75kW | Inlet | 54 | 65 | 76 | 79 | 81 | 85 | 81 | 79 | 89 |
| MBX 18/7 T2 0,75kW | Inlet | 54 | 65 | 76 | 79 | 81 | 85 | 81 | 79 | 89 |
| MBX 20/6 M2 0,37kW | Inlet | 52 | 63 | 74 | 77 | 79 | 83 | 79 | 77 | 87 |
| MBX 20/6 T2 0,37kW | Inlet | 52 | 63 | 74 | 77 | 79 | 83 | 79 | 77 | 87 |
| MBX 20/8 M2 1,1kW | Inlet | 56 | 68 | 79 | 82 | 84 | 88 | 83 | 82 | 91 |
| MBX 20/8 T2 1,1kW | Inlet | 56 | 68 | 79 | 82 | 84 | 88 | 83 | 82 | 91 |
| MBX 22/9 T2 1,1kW | Inlet | 46 | 57 | 68 | 71 | 73 | 77 | 73 | 71 | 81 |
| MBX 22/9 T2 2,2kW | Inlet | 56 | 67 | 78 | 81 | 83 | 87 | 83 | 81 | 91 |
| MBX 25/10 T2 2,2kW | Inlet | 53 | 64 | 75 | 78 | 80 | 84 | 80 | 78 | 88 |
| MBX 25/10 T2 3kW | Inlet | 57 | 68 | 79 | 83 | 85 | 88 | 84 | 82 | 92 |
| MBX 28/11 T2 4kW | Inlet | 61 | 72 | 83 | 86 | 88 | 92 | 88 | 86 | 96 |

Sound / 4 poles

| Sound power Lw dB (A) | | | | | | | | | | |
|-----------------------|-------|-------|--------|--------|--------|---------|---------|---------|---------|-------|
| Model | | 63 Hz | 125 Hz | 250 Hz | 500 Hz | 1000 Hz | 2000 Hz | 4000 Hz | 8000 Hz | Total |
| MBX 12/5 M4 0,08kW | Inlet | 42 | 55 | 61 | 62 | 67 | 68 | 64 | 61 | 72 |
| MBX 12/5 T4 0,08kW | Inlet | 42 | 55 | 61 | 62 | 67 | 68 | 64 | 61 | 72 |
| MBX 14/5 M4 0,08kW | Inlet | 42 | 55 | 61 | 62 | 67 | 68 | 64 | 61 | 72 |
| MBX 14/5 T4 0,08kW | Inlet | 42 | 55 | 61 | 62 | 67 | 68 | 64 | 61 | 72 |
| MBX 16/6 M4 0,08kW | Inlet | 49 | 62 | 68 | 69 | 74 | 75 | 71 | 68 | 79 |
| MBX 16/6 T4 0,08kW | Inlet | 49 | 62 | 68 | 69 | 74 | 75 | 71 | 68 | 79 |
| MBX 22/9 T4 0,37kW | Inlet | 54 | 66 | 73 | 74 | 79 | 80 | 76 | 72 | 85 |
| MBX 25/10 T4 0,75kW | Inlet | 54 | 67 | 73 | 74 | 79 | 80 | 76 | 73 | 85 |
| MBX 28/11 T4 1,1kW | Inlet | 60 | 73 | 79 | 80 | 85 | 86 | 82 | 79 | 91 |
| MBX 31/12 T4 2,2kW | Inlet | 58 | 71 | 77 | 78 | 83 | 84 | 80 | 77 | 89 |
| MBX 35/14 T4 3kW | Inlet | 60 | 73 | 79 | 80 | 85 | 86 | 82 | 79 | 91 |
| MBX 35/14 T4 4kW | Inlet | 59 | 72 | 78 | 79 | 84 | 85 | 81 | 78 | 90 |
| MBX 40/16 T4 5,5kW | Inlet | 63 | 76 | 82 | 83 | 88 | 89 | 85 | 82 | 94 |
| MBX 40/16 T4 7,5kW | Inlet | 67 | 80 | 86 | 87 | 92 | 93 | 89 | 86 | 98 |

| Sound power Lw dB (A) | | | | | | | | | | |
|-----------------------|-------|-------|--------|--------|--------|---------|---------|---------|---------|-------|
| Model | | 63 Hz | 125 Hz | 250 Hz | 500 Hz | 1000 Hz | 2000 Hz | 4000 Hz | 8000 Hz | Total |
| MBX 45/18 T4 7,5kW | Inlet | 70 | 83 | 89 | 90 | 95 | 96 | 92 | 89 | 101 |
| MBX 45/18 T4 11kW | Inlet | 71 | 84 | 90 | 91 | 96 | 97 | 93 | 90 | 102 |

Sound / 6 poles

| Sound power Lw dB (A) | | | | | | | | | | |
|-----------------------|-------|-------|--------|--------|--------|---------|---------|---------|---------|-------|
| Model | | 63 Hz | 125 Hz | 250 Hz | 500 Hz | 1000 Hz | 2000 Hz | 4000 Hz | 8000 Hz | Total |
| MBX 35/14 T6 1,1kW | Inlet | 53 | 66 | 72 | 73 | 78 | 79 | 75 | 72 | 84 |
| MBX 40/16 T6 1,5kW | Inlet | 56 | 68 | 71 | 79 | 79 | 80 | 76 | 72 | 85 |
| MBX 40/16 T6 2,2kW | Inlet | 56 | 68 | 71 | 79 | 79 | 80 | 76 | 72 | 85 |
| MBX 45/18 T6 2,2kW | Inlet | 60 | 73 | 76 | 84 | 84 | 85 | 80 | 76 | 90 |