

## CTH4



ROOF FAN, VERTICAL DISCHARGE

### MANUFACTURING FEATURES

- Fan made of steel with polyester powder finishing coat.
- High efficiency backward impeller with self-cleaning system of steel.
- Standard asynchronous motor with IP-55 protection and Class F insulation. Manufactured with standard voltages: 230/400V 230/400V 50Hz three phase motors

### APPLICATIONS

Specially designed for roof installation, with vertical discharge without any additional kit, they are suitable for:

- Smoke extraction
- Air renewal in buildings and industries.
- Industrial and professional kitchen hoods.
- Maximum continuous operation temperature: 80°C (fluide).
- Maximum ambient temperature: 50°C.
- Cinemas.

## Accessories



**BTI**



**INT**



**SFC**

### UNDER REQUEST

- Version made of inox 304/316.
- Finishing C4-C5.
- Special voltages.
- ATEX version.

## Technical data

### Three-phase motor / 4 poles

Code	Model	R.P.M.	Rated I. A		Rated power kW	Max. Airflow m <sup>3</sup> /h	Sound db (A)**	Weight kg	Connect. diagram
			230V	400V					
278310106	CTH4 315 T4 0,25kW	1400	1,38	0,79	0,25	2.190	43	16	1
278350106	CTH4 355 T4 0,55kW	1440	2,57	1,49	0,55	3.590	48	20	1
278400106	CTH4 400 T4 0,75kW	1410	2,83	1,63	0,75	5.130	51	22	1
278450106	CTH4 450 T4 1,1kW	1450	4,33	2,49	1,10	7.300	54	40	1
278500106	CTH4 500 T4 1,5kW	1450	5,67	3,26	1,50	10.010	57	53	1
278560106	CTH4 560 T4 3kW	1420	10,7	6,17	3,00	14.060	61	58	1

### Three-phase motor / 6 poles

Code	Model	R.P.M.	Rated I. A		Rated power kW	Max. Airflow m <sup>3</sup> /h	Sound db (A)**	Weight kg	Connect. diagram
			230V	400V					
278410106	CTH4 400 T6 0,37kW	900	2,2	1,27	0,37	3.320	41	22	1
278460106	CTH4 450 T6 0,37kW	900	2,2	1,27	0,37	4.730	45	40	1
278510106	CTH4 500 T6 0,75kW	925	3,39	1,95	0,75	6.490	48	53	1
278570106	CTH4 560 T6 0,75kW	925	3,39	1,95	0,75	9.110	51	58	1
278630106	CTH4 630 T6 1,5kW	940	6,45	3,71	1,50	13.230	55	74	1
278710106	CTH4 710 T6 2,2kW	965	10,3	5,94	2,20	18.940	59	106	1
278800106	CTH4 800 T6 4kW	960	16,5	9,46	4,00	27.090	62	113	1

**Notes:**

\*\* Total sound pressure level at the point of maximum flow measured in dB(A) in the suction measured in free field at a distance of 6m from the source

## Dimensions

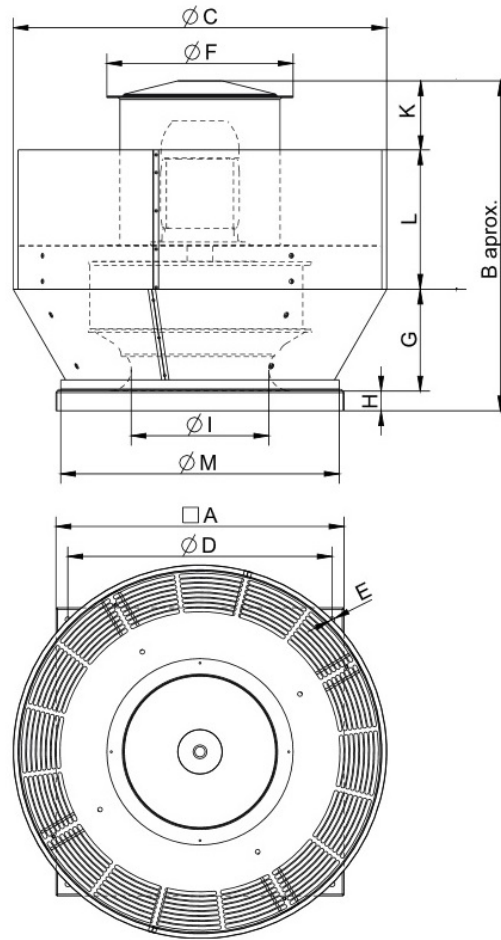

Model	A	B	D	G	H	K	L	ØC	ØE
CTH4 315 T4 0,25kW	450	547.5	390	153	40	140	215	554.5	12
CTH4 355 T4 0,55kW	500	582.5	440	168	40	128	237	622.7	12
CTH4 400 T4 0,75kW	550	637.5	490	193	40	138	267	701.6	12
CTH4 400 T6 0,37kW	550	637.5	490	193	40	138	267	701.6	12
CTH4 450 T4 1,1kW	600	754	540	218	40	198	298	780	12
CTH4 450 T6 0,37kW	600	669	540	218	40	113	298	780	12
CTH4 500 T4 1,5kW	650	771.5	590	237	40	188	307	852	12
CTH4 500 T6 0,75kW	650	771.5	590	237	40	188	307	852	12
CTH4 560 T4 3kW	730	836	670	258	50	175	353	946.6	14
CTH4 560 T6 0,75kW	730	836	670	258	50	175	353	946.6	14
CTH4 630 T6 1,5kW	830	877	770	290	50	157	380	1083.6	14
CTH4 710 T6 2,2kW	920	940	860	323	50	125	442.5	1200.7	14
CTH4 800 T6 4kW	1020	1096.5	960	358	50	247	442	1340	14

Model	ØF	ØI	ØM
CTH4 315 T4 0,25kW	374	210	428
CTH4 355 T4 0,55kW	374	236	478
CTH4 400 T4 0,75kW	374	266	528
CTH4 400 T6 0,37kW	374	266	528
CTH4 450 T4 1,1kW	434	300	578
CTH4 450 T6 0,37kW	374	300	578
CTH4 500 T4 1,5kW	434	335	628
CTH4 500 T6 0,75kW	434	335	628
CTH4 560 T4 3kW	472	374	706
CTH4 560 T6 0,75kW	472	374	706
CTH4 630 T6 1,5kW	472	422	802
CTH4 710 T6 2,2kW	472	472	892
CTH4 800 T6 4kW	600	532	992

# Wiring diagram

Wiring diagram N° 1

230/400V

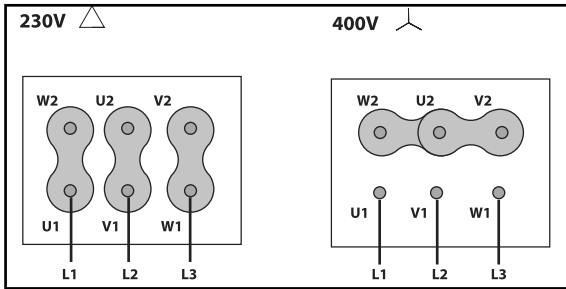

400/690V

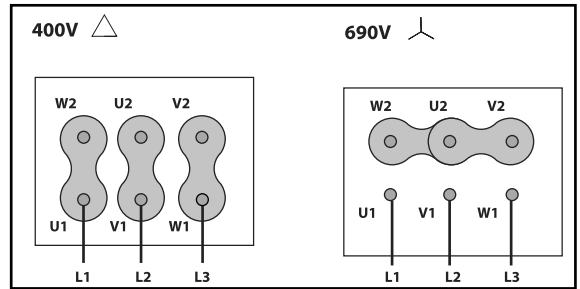

# CHARACTERISTIC CURVE

1	CTH4 315 T4 0,25kW	2	CTH4 355 T4 0,55kW	3	CTH4 400 T4 0,75kW	4	CTH4 450 T4 1,1kW
5	CTH4 500 T4 1,5kW	6	CTH4 560 T4 3kW				

## AIR FLOW - PRESSURE

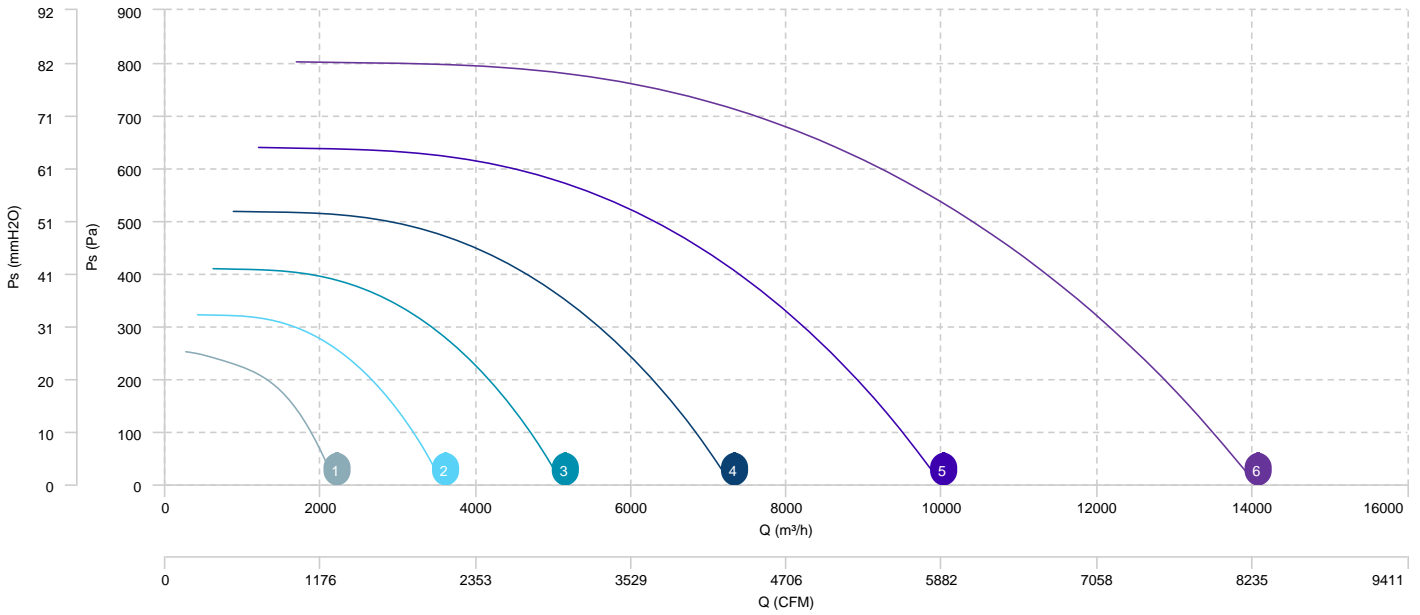

## AIR FLOW - ABSORBED POWER

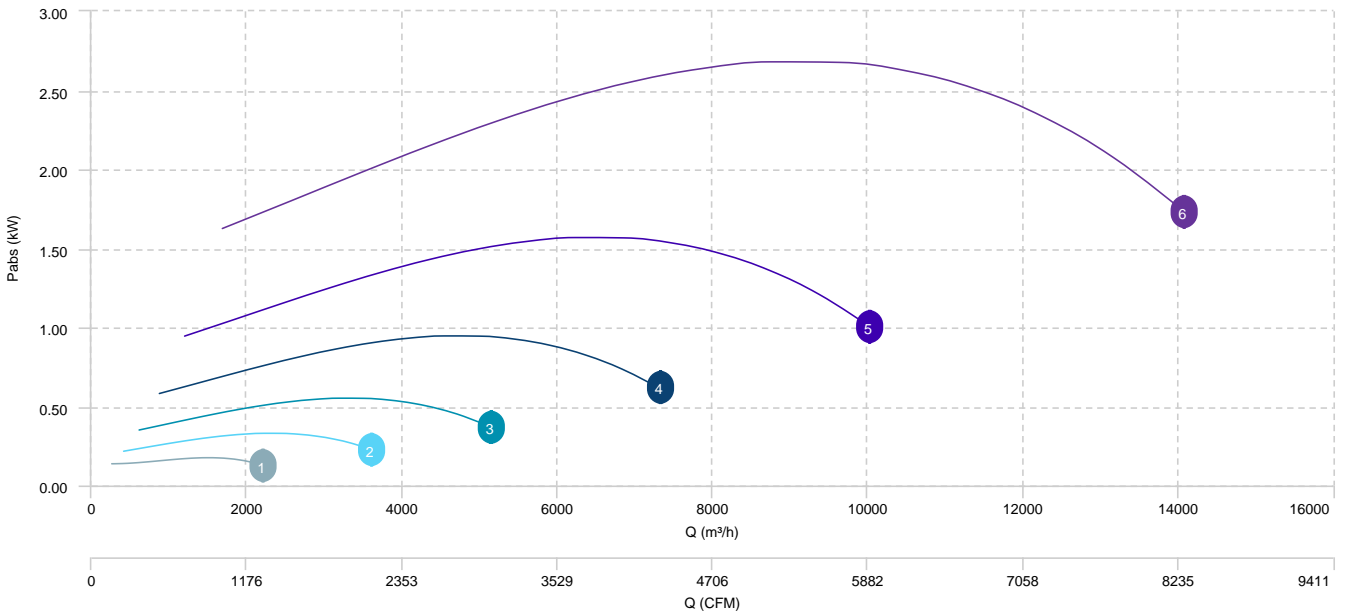

1	CTH4 400 T6 0,37kW	2	CTH4 450 T6 0,37kW	3	CTH4 500 T6 0,75kW	4	CTH4 560 T6 0,75kW
5	CTH4 630 T6 1,5kW	6	CTH4 710 T6 2,2kW	7	CTH4 800 T6 4kW		

## AIR FLOW - PRESSURE

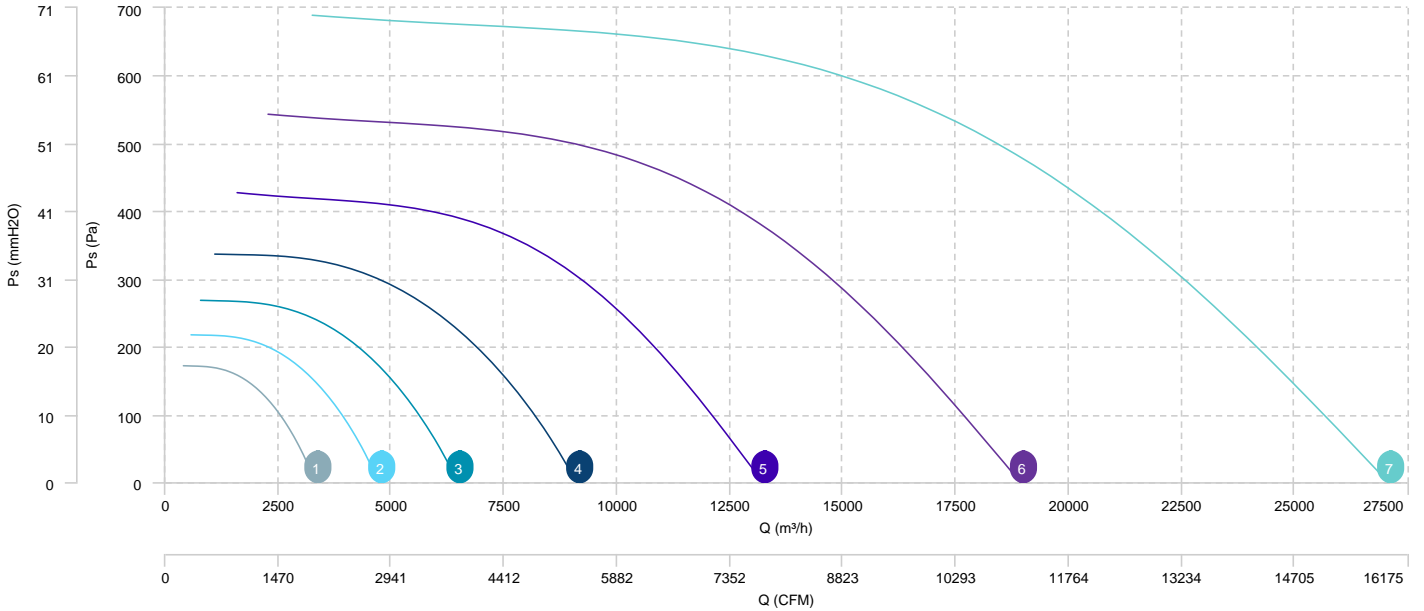

## AIR FLOW - ABSORBED POWER

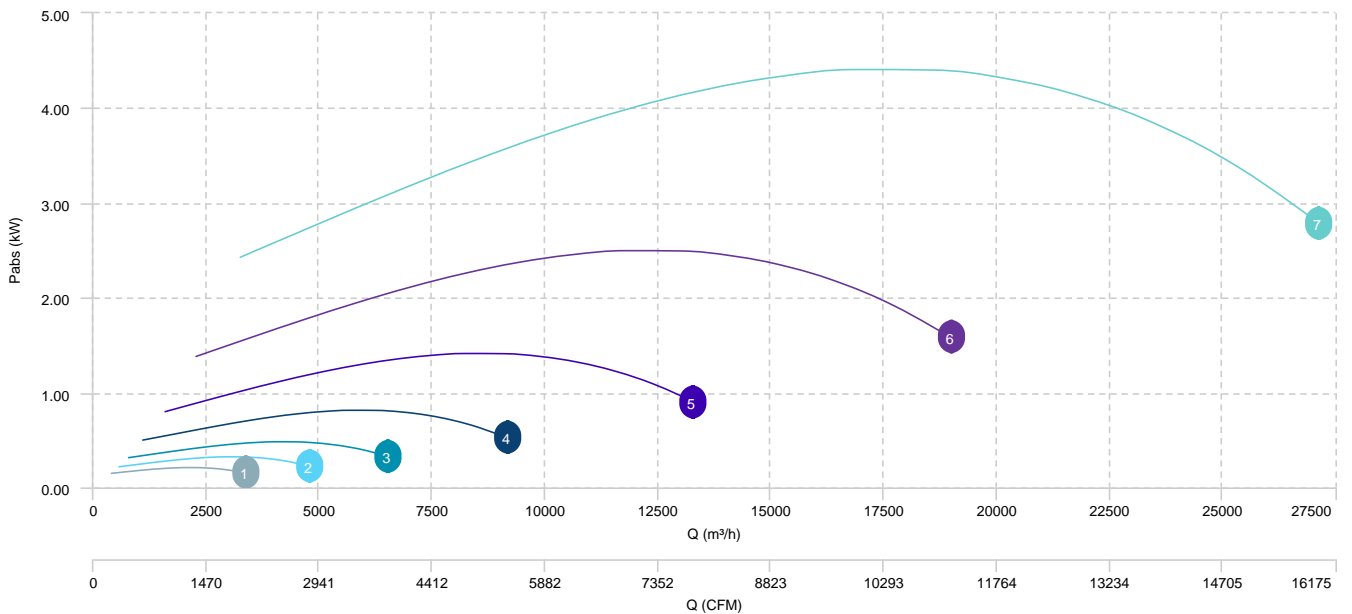

## Sound data

### Sound / 4 poles

Sound power Lw dB (A)										
Model		63 Hz	125 Hz	250 Hz	500 Hz	1000 Hz	2000 Hz	4000 Hz	8000 Hz	Total
CTH4 315 T4 0,25kW	Inlet	46	54	59	62	63	62	58	55	69
CTH4 355 T4 0,55kW	Inlet	51	59	64	67	68	66	63	60	74
CTH4 400 T4 0,75kW	Inlet	54	62	67	70	71	69	66	63	77
CTH4 450 T4 1,1kW	Inlet	58	66	70	74	75	73	70	67	80
CTH4 500 T4 1,5kW	Inlet	61	69	74	77	78	76	73	70	83
CTH4 560 T4 3kW	Inlet	64	72	77	80	81	80	76	74	87

### Sound / 6 poles

Sound power Lw dB (A)										
Model		63 Hz	125 Hz	250 Hz	500 Hz	1000 Hz	2000 Hz	4000 Hz	8000 Hz	Total
CTH4 400 T6 0,37kW	Inlet	45	53	57	61	62	60	57	54	67
CTH4 450 T6 0,37kW	Inlet	48	56	61	64	65	64	60	57	71
CTH4 500 T6 0,75kW	Inlet	52	60	64	67	69	67	64	61	74
CTH4 560 T6 0,75kW	Inlet	55	63	68	71	72	70	67	64	77
CTH4 630 T6 1,5kW	Inlet	59	67	71	74	76	74	71	68	81
CTH4 710 T6 2,2kW	Inlet	62	70	75	78	79	77	74	71	85
CTH4 800 T6 4kW	Inlet	66	74	78	82	83	81	78	75	88