

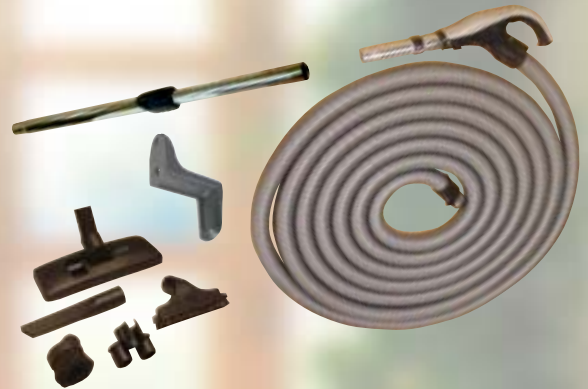

Accessories for Central Vacuum Systems



Hoses & cleaning tools



Pipes, fittings and valves

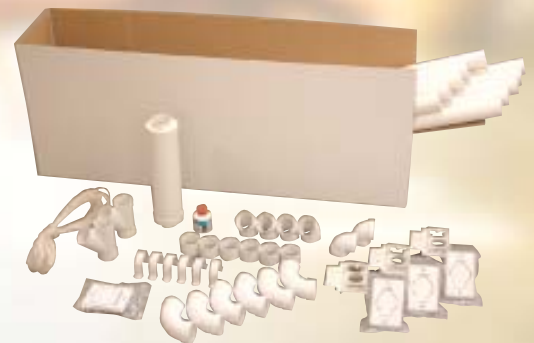

Others on request -Filters, bags, motors & control-boards

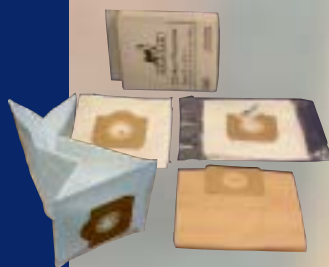

AirVac -Your partner in Central Vacuums !

Your full-range partner in Central Vacuum Systems. We provide Your company with a complete range of units, from smallest residential to the full-size commercial, Hoses and accessories, tubings and installation kits etc.. You are also welcome to have Your units labelled with **Your trademark**.

AirVac Luft & Vacuumteknik AB

P.O. Box 1
S-121 21 Johanneshov, SWEDEN

Visit adress:
Bogårdsvägen 45A, Sköndal

Tel. +46 8 390010
Fax. +46 8 390005
E-mail: info@airvac.se

Internet website
www.airvac.se

Tools, hoses & complete kits

Standard Hose & Tool Kit

Crushproof hose in Ø32mm in lengths of 8, 9, 10.5 or 12m



LV-Hose & Tool Kit

LV-hoses Ø35mm in lengths of 8, 9, 10,5 or 12m. Different handles and colours available on request.



Standard hose

Crushproof lightweight hose in Ø32mm in lengths of 8, 9, 10.5 or 12m



LV-Hose (on/off)

LV-hoses Ø32 or 35mm in lengths of 8, 9, 10,5 or 12m. Different handles and colours available on request.



Complete Standard Hose Tool-Kits

All kits includes silvergrey Hose with plastic handle (swiveled) and hose-end for pin jack valves, hose-hanger, Steplock tele-scopic wand 36-CTT-5-32 in cromed steel, Combination floor tool 36-N5ND32, Set 36-CND32 including a wand Tool- caddie, Crevice tool, Dust-brush and Slide-on Upholstery with soft brushes.

Code No.	Hose	Qty/pallet	Box size, cm	Kg/Kit
33-SS08MST	8m	36	57x38x19	3,9
33-SS09MST	9m	36	57x38x19	4,2
33-SS10MST	10m	36	57x38x19	4,4
33-SS12MST	12m	36	57x38x19	4,6

Complete LV- Hose Tool-Kits

All kits includes silvergrey LV-Hose with ERGO-handle with swivel, on/off switch and hose-end for pin jack valves, hose-hanger, Quick-lock telescopic wand 0101-CS32 in cromed steel, Combination floor tool 36-N5ND32, Set 36-CND32 including a wand Tool- caddie, Crevice tool, Dust-brush and Slide-on Upholstery with soft brushes.

Code No.	Hose	Qty/pallet	Box size, cm	Kg/Kit
33-SS08MSW	8m	28	57x38x19	4,5
33-SS09MSW	9m	28	57x38x19	4,8
33-SS10MSW	10m	28	57x38x19	5,2
33-SS12MSW	12m	28	57x38x19	5,6

Standard hose

Crushproof lightweight hose in Ø32mm including plastic handle with swivel and air-relief slide switch. Packed in strong Export well-boxes.

Code No.	Hose	Qty/box	Box size, cm	Kg/box
36-EH32SG08	8m	20	80x80x50	35
36-EH32SG09	9m	18	80x80x50	33
36-EH32SG10	10m	15	80x80x50	35
36-EH32SG12	12m	12	80x80x50	32

LV-Hose (on/off)

LV-hoses Ø32 or 35mm (standard) including ERGO-handle with on/off switch, extension-pipe in chrome/steel with air-relief ring. Packed in strong Export well-boxes.

Code No.	Hose	Qty/Box	Box size, cm	Kg/box
69-VH35SG07	7m	8	51x115x26	20
69-VH35SG08	8m	8	51x115x26	22
69-VH35SG09	9m	6	51x115x26	22
69-VH35SG10	10m	6	51x115x26	23
69-VH35SG12	12m	6	57x115x26	25



36-N5ND32



36-N31



38-NE00



36-CTT-5-32

06-B-1050



36-AB32

0101-CS32



36-C6ND32-4



36-C6ND32-2



36-C6ND32-1



38-F02300

36-C6ND32-3



36-PH4-32



36-PH5-32



36-PH3-32

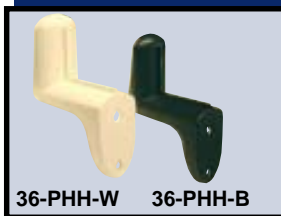

36-PHH-W



36-PHH-B



36-EC32H

FloorTools

The 36-N5ND32 and its cousin, the 38-NE00 wheeled-version, offer functionality on a variety of floor surfaces, moving from hard floor to carpet with the use of a foot pedal. Both tools have a durable metal backplate support with longer brushes. The wheeled version has a rubber blade in back of the bottom, and a special plate with soft pads to add for sensitive wooden floors. A double swivel neck keeps the tool parallel to the floor and adds to its maneuverability in tight places. Type 36-N31 is a double-inlet, low profile floor tool as seen on TV! Colour on request!

Code No.	widht cm	Qty/Box	Description
36-N5ND32	27	40	Combination tool w. pedal
38-NE00	26	20	Combination tool w. pedal/wheels

Commercial FloorTools

Multipurpose nozzle with accessories for commercial and industrial floor cleaning. The different accessories are easily attached to the frame-tool and locked by slide-switches.

Code No.	widht cm	Qty/Box	Description
38-MULT375	375	30	Frame floor tool
38-MULT375BR	375	90	Insert with brushes for bare floor
38-MULT375CRP	375	90	Insert for carpets
38-MULT375W	375	90	Insertfor Wet pick-up

Telescopic wands

Steplock wands Ø32 in Crome/steel and "Quicklock" wand Ø32 in Cromed steel or black Aluminum

Code No.	Material	Type	Min/Max cm	Kg
36-CTT-5-32	Crome/steel	Steplock	59/100	0,61
06-B-1050	Crome/steel	Steplock	60/99	0,55
0101-CS32	Crome/steel	Quick-lock	60/98	0,63
36-AB32	Aluminum	Quick-lock	56/97	0,29

Brushes and nozzles

This serie is a full featured set of attachments that meets a wide range of cleaning needs. The Ø32mm neck engages all standard wands and a large cleaning orifice to ensure continuous cleaning. They meet the needs for a basic attachment set with a finish comparable to higher priced sets. Both slide-on upholstery brush and dustbrush with natural fill for gentle cleaning. The Wand tool caddy makes it convenient to move around with all your above the floor accessories.

- 36-C6ND32-1 Crevice tool (Black ABS plastic)
- 36-C6ND32-2 Tool Caddy for wand (Black ABS plastic)
- 36-C6ND32-3 Upholstery nozzle w. slide-on brush (natural fill)
- 36-C6ND32-4 Dusting brush (Black ABS plastic w. natural fill)
- 38-F02300 Radiator brush (Black ABS plastic/nylon fill)

Hose handles (black plastic)

- 36-PH4-32 Handle with air-relief and slide dust-brush and swivel.
- 36-PH5-32 Curved Handle with air-relief and swivel.
- 36-PH3-32 Curved Handle with air-relief and swivel.

Hose hanger

36-PHH-W(white) and 36-PHH-B(black), plastic hose hangers for installation on single stud. -Compact and slim! Easy installation! Fits all hoses!

Hose-end w. metal-ring for 1¼" (32mm) valves

36-EC32H, fits all Ø32mm hoses. Integrated metal-ring for valves and inlets of Pin-jack model.



Valves, Pipes & Fittings



Complete Piping & Inlet Kits

Compact kits including pipes, inlet-Valves and fittings made in white 2" OD PVC. Kits with 1, 2 or 3 inlets. Silencer and pipe straps etc. can be added to kits on demand. 21 boxes/EUR-pallet (0,8x1,2m).

Code No.	Ø2" tube	Wall inlet	Mount. plate	90°short El	90°sweep	45° El	Coupling	Wye 45°	pvc Glue	exhaust vent	LV wire
33-IP1	6m	1	1	1	2	-	3	-	1	1	6m
33-IP2	12m	2	2	2	4	4	6	1	1	1	15m
33-IP3	18m	3	3	3	6	8	8	2	1	1	20m

PVC tubes and Fittings

A complete range of 2" (Ø50,8mm) tubing system in white PVC for best function of residential Central Vacuum Systems. Convenient tool for pipe cutting type **02-SV6700**.

Inlet valves and accessories

A standard range of wall inlets in plastic and diecast metal. Metal or plastic mounting plate for walls, or adaptor for floor mounting.

Item	Code No.	Pcs/box	Item	Code No.	Pcs/box
Ø2" PVCpipe 1,15m	02-SV1115	25	Exhaust vent Silencer	02-SV8092	12
Ø2" PVCpipe 2,5m	02-SV7600	7	Wall inlet White plastic	02-SV8016	24
Ø2" Stop coupling	02-SV8062	200	Inlet trimplate	02-SV8022	0
Ø2" Slip coupling	02-SV8066	200	Wall inlet White metal	02-SV8021-1	20
Pipe strap	02-SV8088	200	Wall/floor inlet Brass	02-SV8020-2	20
Ø2" Cap slip	02-SV8080	50	Metal mounting plate	02-SV8005	50
Ø2" 90° short elbow	02-SV8052	115	Plastic mounting plate	02-SV8001	75
Ø2" 90° sweep elbow	02-SV8042	115	INOX wall inlet	33-INOX86	20
Ø2" 90° sweep m/f	02-SV8046	115	Mouning plate for INOX	33-765569W	20
Ø2" 45° elbow	02-SV8056	125	Utility valve White	02-SV8160	15
Ø2" 45° elbow m/f	02-SV8060	125	Inlet-valve extension	02-SV8082	50
Ø2" Short Tee	02-SV8068	150	LowVoltage wire 2x0,6	33-EKKR 2x0,6	100/500m
Ø2" 90° sweep Tee	02-SV8048	45	VacPan white	02-SV8190	20
Ø2" 45° Wye	02-SV8072	45	VacPan black	02-SV8190-1	20
Ø2" 3-way 45°	02-SV8070	65	Trimplate for VacPan W	02-SV8195W	50
Ø2" inlet adapter	02-SV8081	50	Trimplate for VacPan B	02-SV8195B	50
PVC Glue/cement	02-SV6010	24	Black curved flange 2"	36-8029B	300
Exhaust vent cap	02-SV8118	40	White curved flange 2"	36-8029W	300



02-SV1115
02-SV7600



02-SV6700



02-SV8062
02-SV8066



02-SV8088



02-SV8080



02-SV8052

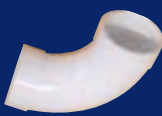

02-SV8042



02-SV8046



02-SV8056



02-SV8060



02-SV8068



02-SV8048



02-SV8072



02-SV8070



02-SV8081



02-SV6010



02-SV8118



02-SV8092



36-8092B



36-8029W



Flange gasket



02-SV8016



02-SV8022



02-SV8021-1



02-SV8020-2

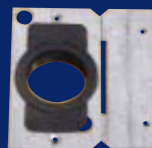

02-SV8005

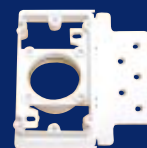

02-SV8001



33-INOX86



33-765569W



02-SV8160



02-SV8082



33-EKKR2x0,6



02-SV8190 (White)
02-SV8190-1 (black)